



SPECIOUS  
**2/3 BHK**  
DELUXE FLATS

A PROJECT BY



QUALITY LIVING FROM THE TEAM THAT CARES

# *Mateshwari*

— RESIDENCY —

*Peace of Mind*

We don't sell homes but give a shape to your dreams





*Mateshwari*  
— RESIDENCY —

# BASEMENT FLOOR PLAN

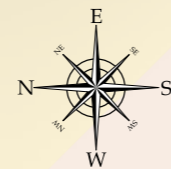
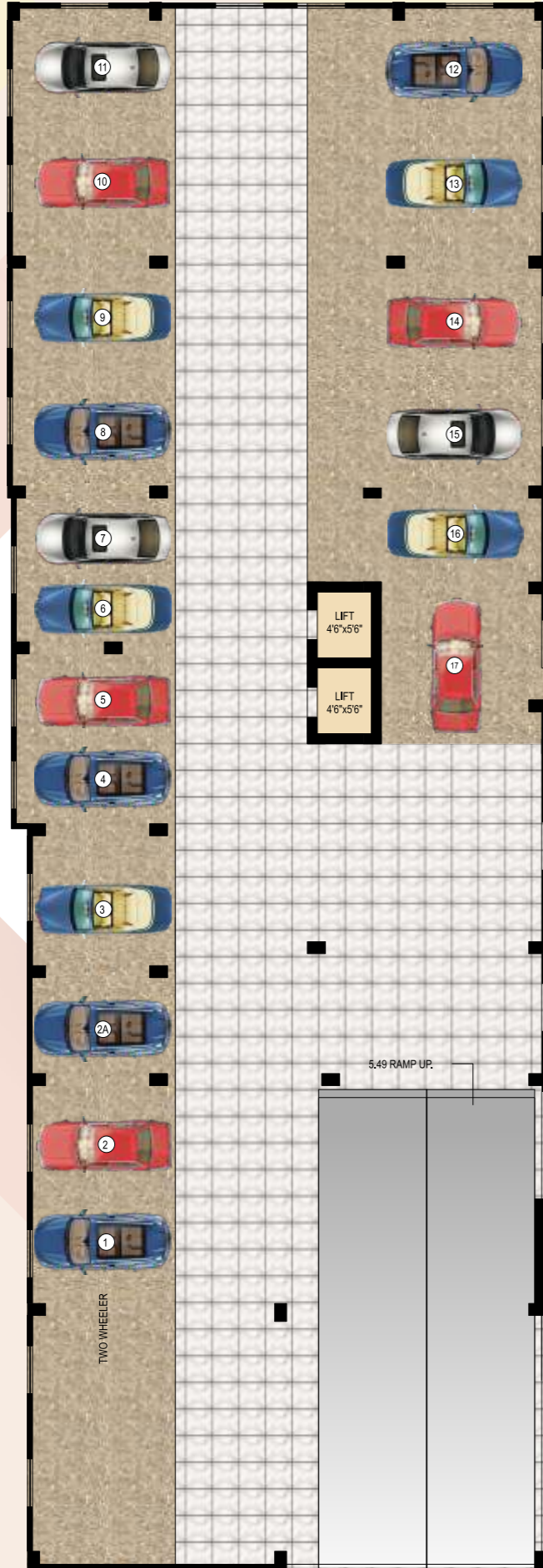

# GROUND FLOOR PLAN

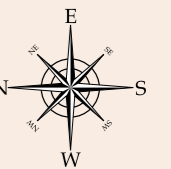
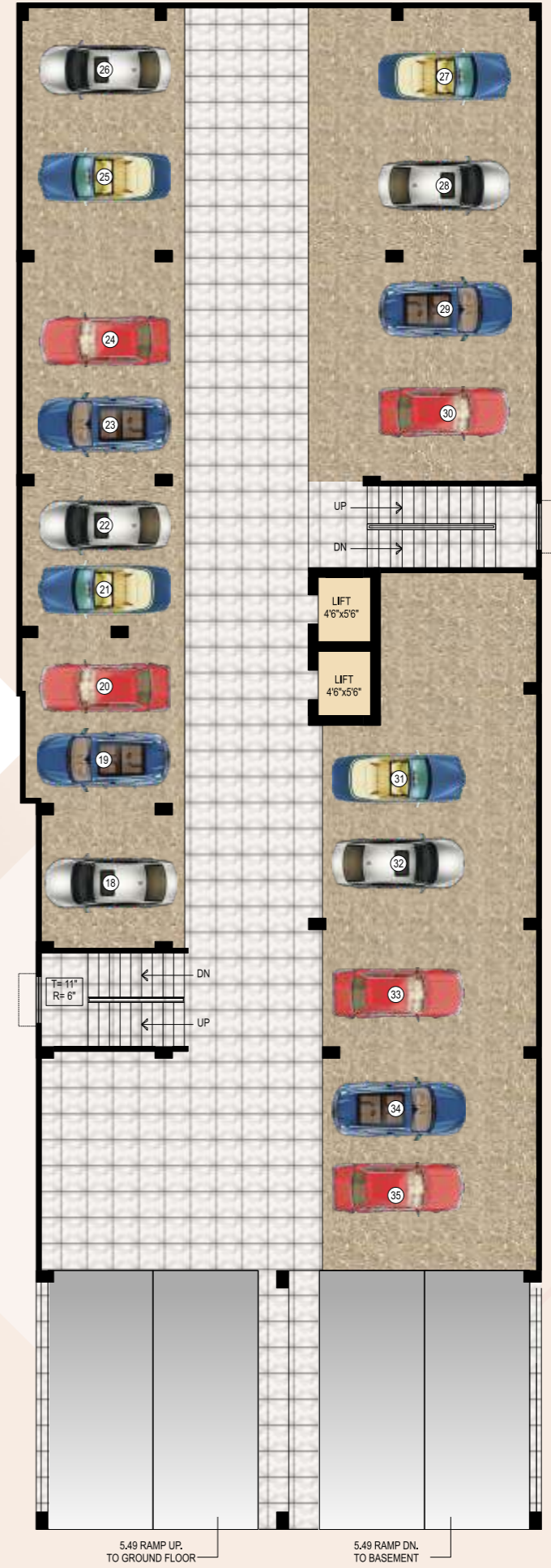

# 1<sup>ST</sup> FLOOR PLAN



Flat #	Carpet Area	Balcony Area	B/U Area	S-B/U Area
01	845 sft.	40 sft.	925 sft.	1205 sft.
02	780 sft.	40 sft.	860 sft.	1120 sft.
03	655 sft.	50 sft.	755 sft.	985 sft.
04	845 sft.	40 sft.	925 sft.	1205 sft.
05	845 sft.	40 sft.	930 sft.	1210 sft.
06	650 sft.	36 sft.	735 sft.	955 sft.

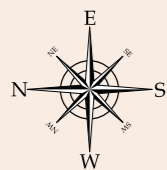

# 2<sup>ND</sup> TO 5<sup>TH</sup> FLOOR PLAN



Flat #	Carpet Area	Balcony Area	B/U Area	S-B/U Area
01	845 sft.	104 sft.	990 sft.	1290 sft.
02	775 sft.	100 sft.	920 sft.	1200 sft.
03	655 sft.	50 sft.	755 sft.	985 sft.
04	845 sft.	104 sft.	990 sft.	1290 sft.
05	845 sft.	104 sft.	995 sft.	1295 sft.
06	650 sft.	36 sft.	735 sft.	955 sft.

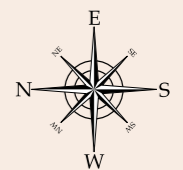

# 6<sup>TH</sup> FLOOR PLAN

*Spacious Modern Living.*



Flat #	Carpet Area	Balcony Area	B/U Area	S-B/U Area
01	795 sft.	----	1315 sft.	1710 sft.
02	655 sft.	50 sft.	755 sft.	985 sft.
03	826 sft.	----	1365 sft.	1775 sft.
04	650 sft.	36 sft.	735 sft.	955 sft.

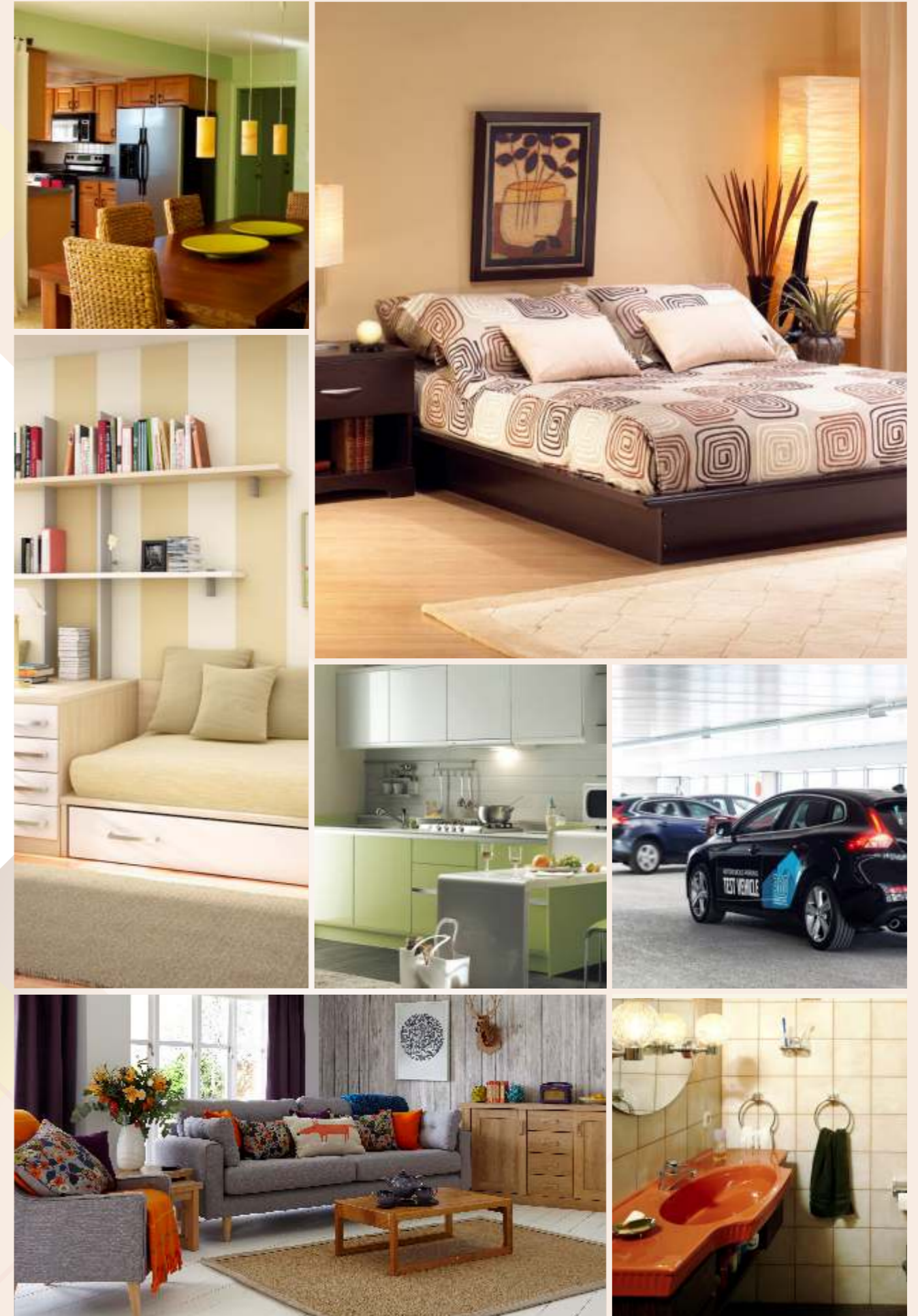
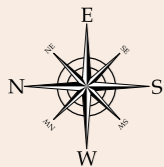

## Specifications

STRUCTURE	:	RCC Frame Structure with Earthquake resistance.
SUPER STRUCTURE	:	1st Class Brick work in Cement Sand Mortar.
FLOORING	:	Vitrified Tiles Flooring inside the Flat. Except Toilet & Kitchen.
DOORS & WINDOWS	:	Chowkhat of Salwood, Door Shutter will be of Flush Door Painted with two coats of enamel paint. Fully Glazed window with wooden/aluminium frame.
KITCHEN	:	Kitchen top will be of Granite Stone with Steel Sink, Glaze Tiles dodo upto 2' high from working platform & Floor will be Ceramic Tiles.
TOILETS	:	Glazed Tiles on wall up to Lintel level, Floor will be Ceramic tiles, Chinaware will be of Hindware/Parryware make and C.P fitting will be ESSCO/Hindware/Parryware.
ELECTRICAL	:	Copper Wiring in Concealed P.V.C Conduits. Power Plug in D/D, Bedrooms, Toilets and Kitchen.
FINISHING	:	All walls will be finished with Wall Putty.
SERVICE	:	Telephone Point (not connection) in each flat. PBX facility from each flat to security point.
WATER	:	24 Hours water supply from own Tube well.
POWER BACKUP	:	300Watts Power in each flat from silent Gen-Set.
LOANS	:	Loan facility available from Bank / Financial Institution.
NOTE	:	Payment are to be made by Cheque/Bank Draft in favour of Sri Mateshwari Constructions at Patna.

## Location

Not to scale

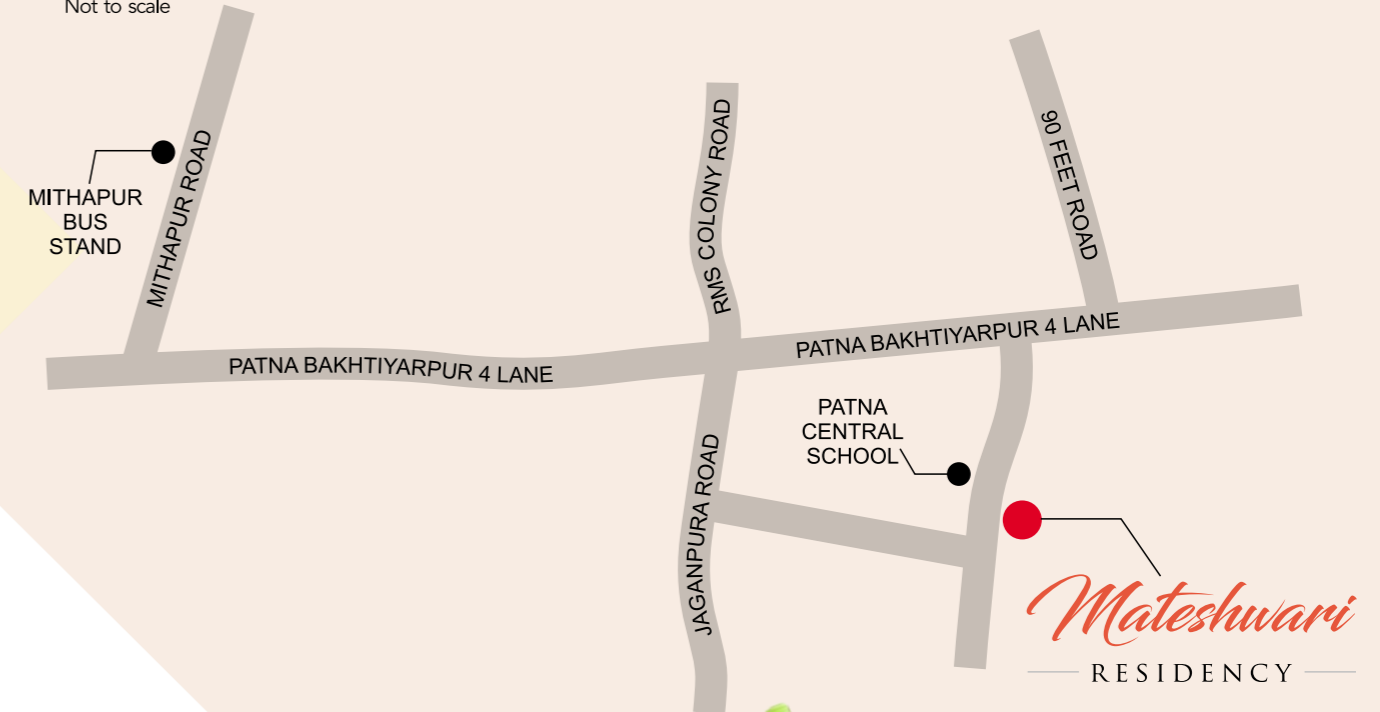

### Distances From

Zero Mile .....	4.0 Km
Mithapur Bus Stand.....	2.98 Km
Patna Junction .....	4.5 Km
Patna Central School.....	28 Mtr



## Mode of Payment

- At the time of Booking .....10% of sale price
- After completion of Foundation .....20%
- After completion of Ground Floor Slab .....10%
- After completion of 1st Floor Slab.....10%
- After completion of 2nd Floor Slab .....5%
- After completion of 3rd Floor Slab .....5%
- After completion of 4th Floor Slab .....5%
- After completion of 5th Floor Slab .....5%
- After completion of 6th Floor Slab .....5%
- After completion of Brick Work .....10%
- After completion of Plaster Work .....10%
- One Month before Possession.....5%

Ample Parking/Lift/Transformer/Generator for charge each flat will be ₹ 3,75,000/- only

## Features of Building & Common Areas

<b>Parking Space</b>	Sufficient car parking Space provided for all flats and their easy movement to enter and exit the building.
<b>Water Supply</b>	Round the clock water supply, insulated water tanks.
<b>Lift</b>	Of a known, reliable, branded company.
<b>Generator with auto-changer</b>	Suitable capacities silent generator with auto-changer, to be installed.

Note: Extra charges for cupboards, shelves, extra electrical points, power plugs, telephone points and modifications or alterations other than agreement shall be borne by flat purchasers only.  
Registration charges, GST extra.



108, Hariom Commercial Complex  
New Dakbunglow Road, Patna - 800 001 (Bihar)  
Tel. : 0612-2216335, 9334117578, 9334837720